

# VersiDrain® 6P

Under-screed  
Drainage Sheet



**VersiDrain® 6P** is a lightweight, plastic drainage sheet that is positioned between the structural slab and a topping screed.

**VersiDrain® 6P** creates a drainage and ventilation cavity that allows entrapped water in the screed to escape via drainage channels and perforations in the mat. Water and salts in the screed are prevented from migrating upward, via capillary action, to the surface to form unsightly efflorescence and algae on tiles, stone or paved surfaces.

**VersiDrain® 6P** acts as a separation layer thereby reducing surface cracking caused by the expansion of entrapped water and structural movement. Reducing the amount of water in the screed can also prevent frost damage to paved surfaces.

When laid on waterproofing membranes, **VersiDrain® 6P** provides temporary protection against damage caused by on-site labour and heavy equipment.

## Applications

Typical areas of application include:

- Balconies, terraces and podium decks
- Swimming pool decks and patios
- Change and wash rooms and shower areas

## Advantages

- Effective drainage under tiled or paved surfaces
- Minimises efflorescence and algae build-up
- High strength waterproof membrane protection
- Reduces surface cracking
- Easy to handle and install
- Snap-on interlocking modules reduce overlap waste
- Root resistant and rot-proof
- Resistant to salts, inorganic acids and ground chemicals

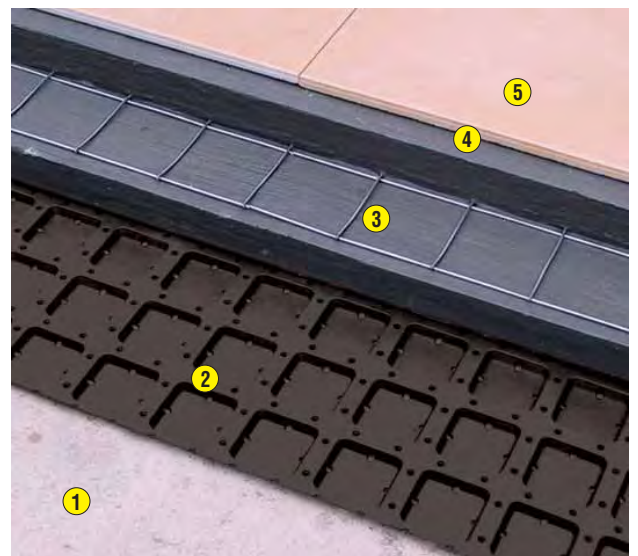

- ① Floor Slab
- ② VersiDrain® 6P
- ③ Reinforcing Mesh
- ④ Cement and Sand Screed / Concrete
- ⑤ Floor tile (if required)

*Note: A minimum screed thickness of 50 mm is required.*

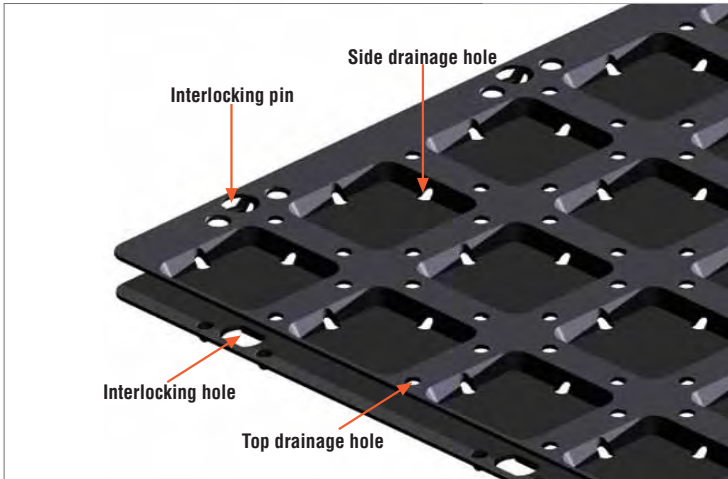

## Specifications

<b>Material</b>	Polypropylene
<b>Sheet thickness</b>	1.2 mm
<b>Overall height</b>	6 mm
<b>Compressive strength</b>	
Unfilled	> 80 t/m <sup>2</sup>
With Grade 20 cement/sand screed	> 1,500 t/m <sup>2</sup>
<b>Service temperature</b>	-30° C to 120° C
<b>Biological/Chemical resistance</b>	Resistant to ground chemicals, rot, molds, algae, bacteria and root penetration. Does not affect potable water.
<b>Fire resistance</b>	B2 (DIN 4102)

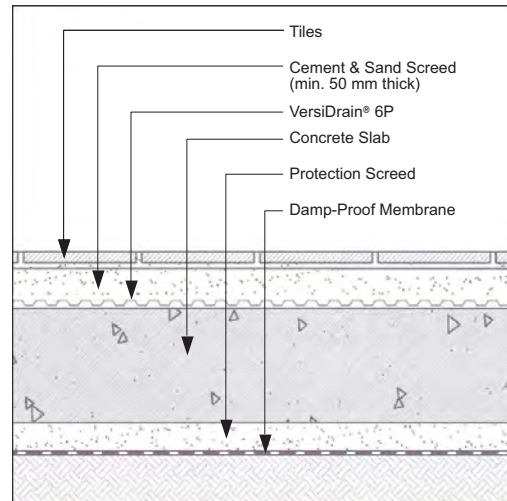

Ground Slab Detail

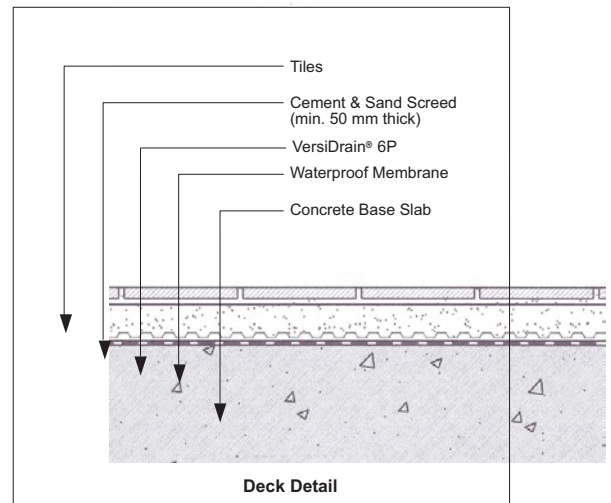

Deck Detail

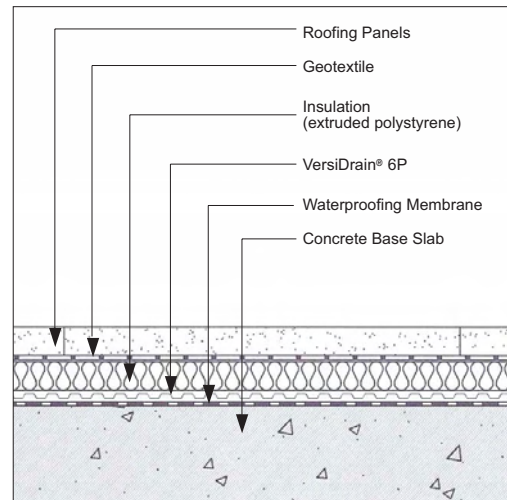

Inverted Roof Detail



**Note:** The information provided in this brochure is based on current knowledge and experience and does not infer any legally binding assurance or warranty, expressed or implied. Intending purchasers should verify whether any changes to specifications or applications or otherwise have been made since this literature was issued. The products in this brochure are manufactured using specified recycled plastics under detailed quality control standards and procedures. Factors including source of raw material and manufacturing processes may impact slightly on the strength of the modules.

[www.elmich.com](http://www.elmich.com)

Distributed by: